

## Inside

- ❖ Fly of the Month: Madison River Improved Zelon Midge
- ❖ Club Trips for 2020
- ❖ Three Month Calendar

## Highlights

- Page 4: Awards & Installation Dinner
- Page 6: Southwestern Tournament Results
- Page 10: Welcome Back, Sockeye Salmon!

# Target Talk

NEWSLETTER OF THE LONG BEACH CASTING CLUB, ESTABLISHED 1925

APRIL 2020

WWW.LONGBEACHCASTINGCLUB.ORG

## Leader's Line...

# Cancellation of LBCC Events Until Further Notice

COLIN KUMABE, PRESIDENT

In an abundance of caution and concern for the health and safety of club members and guests, the Long Beach Casting Club will be suspending the following events until further notice:

- ❖ 3/14 Saturday 8:30 AM Fly Line Cleaning
- ❖ 3/17 Tuesday 7:00 PM Beginning Fly Casting
- ❖ 3/18 Wednesday 12:00 PM Noon Lunch; 7:00 PM Fly Tying Forum
- ❖ 3/21 Saturday 8:00 PM Pond Cleaning
- ❖ 3/22 Sunday Director's Handicap
- ❖ 3/24 Tuesday 7:00 PM Beginning Fly Casting
- ❖ 3/25 Wednesday 7:00 PM Fly Tying Forum; 7:00 PM Kelsey Bass Ranch Pre-Trip
- ❖ 3/26 Thursday 7:00 PM Monthly Meeting: John Sherman
- ❖ 3/31 Tuesday 7:00 PM Beginning Fly Casting
- ❖ 4/1 Wednesday 7:00 PM Fly Tying Forum
- ❖ 4/2 Thursday 7:00 PM Annual General Meeting
- ❖ 4/7 Tuesday 7:00 PM Beginning Fly Casting
- ❖ 4/8 Wednesday 7:00 PM Fly Tying Forum
- ❖ 4/15 Wednesday 12:00 PM Noon Lunch; 7:00 PM Fly Tying Forum
- ❖ 4/18 Saturday 9:00 AM Pre-Trip: Green River #1, #2, #3; 5:00 PM Awards & Installation Dinner
- ❖ 4/22 Wednesday 7:00 PM Fly Tying Forum
- ❖ 4/29 Wednesday 7:00 PM Fly Tying Forum

The following two trips are **NOT** cancelled:

- ❖ 4/9-10 Week Kelsey Bass Ranch w/ Mick Woodbury
- ❖ 4/26-5/1 Week Green River #1 w/ Yash Iseda

For information about these trips, please contact Mick Woodbury and Yash Iseda.

Thank you for your understanding.

# Club Trips for 2020

## ART DAILY, 2<sup>ND</sup> VICE PRESIDENT

TRIP DATE	TRIP & LEADER
April 9–10	Kelsey Bass Ranch w/ Mick Woodbury, Pre-Trip March 25, 7:00 PM
Apr 26–May 1	Green River, Utah #1 w/ Yash Iseda, Pre-Trip Cancelled
May 3–8	Green River, Utah #2 w/ Colin Kumabe, Pre-Trip Cancelled
May 10–15	Green River, Utah #3 w/ Paul Burgner, Pre-Trip Cancelled. Spots still available!
May 24	On the Bay Salt Trip w/ Mark Flo and Kevin Green 6:00 AM, Pre-Trip May 12, 7:00 PM
May 30–Jun 3	Pyramid Lake w/ Paul Nakamura, Pre-Trip May 16, 9:00 AM–Noon
July 23–26	Brookie Bash w/ Mark Flo, Pre-Trip July 8, 2020, 7:00 PM, "Brookie Day" is July 25
July 24	Sierra Tenkara Event w/ C. O'Dell, Pre-Trip July 8, 2020, 7:00 PM
August 4	Local Tenkara Event w/ Art Strauss, Details TBD
Aug, Sep TBD	Eastern Sierra Backpacks w/ Jim Garvey, Pre-Trip TBD
Sep 19	Yards & Inches w/ M. Woodbury, Pre-trip Sep. 9, 2020 7:00 PM
Aug-Oct TBD	Conejos or San Juan River w/ T. O'Brien, Pre-trip TBD
Aug-Oct TBD	"Quiet Fisherman" w/ T. Komisak, Pre-trip TBD
Nov TBD	NorCal Steelhead w/ Marc Bonvouloir, Pre-trip TBD

**T**rip deposits for trips that are 'double occupancy' and require deposits in advance are non-refundable. Should you need to cancel, your money will be refunded only if another club member replaces you.

Trips are subject to change, so monitor Target Talk or the web calendar for the latest information. If you would like to be a streamkeeper and need help organizing a club trip, let me know. Please contact me if you have any suggestions for a trip or any questions at [dailya42@yahoo.com](mailto:dailya42@yahoo.com).



## Got Photos?

If you have a great photo that would be of interest to your fellow members send it along to our Social Media guy, Tom O'Brien. It just might end up on Facebook or Instagram! Send 'em to Tom at:

[obrien579@yahoo.com](mailto:obrien579@yahoo.com)

# OFFICERS

## PRESIDENT

COLIN KUMABE  
(562) 221-9418

## 1<sup>ST</sup> VICE PRESIDENT

STEVE JONES  
(562) 682-7920

## 2<sup>ND</sup> VICE PRESIDENT

ART DAILY  
(714) 335-4628

## CO-CAPTAINS

MARK FLO: (562) 420-8121  
MIKE IVY: (714) 720-6599

## MEMBERSHIP SECRETARY

WAYNE SAKAGUCHI  
(714) 264-2135

## TREASURER

TOM MCGIVERN  
(310) 947-4212

## CORRESPONDING SECRETARY

BRAD LANDON  
(714) 323-0586

## FACILITIES & POND

STEVE HIGASHI  
(562) 508-8219

## SENIOR DIRECTOR

DAN RIVETT  
(562) 431-2738

## JUNIOR DIRECTOR

YASH ISEDA  
(562) 596-7766

## TARGET TALK EDITOR

ROB PETERSON  
(310) 963-2515

# Happy 95<sup>th</sup> Anniversary LBCC (April 11)!

COLIN KUMABE, PRESIDENT

**T**he Long Beach Casting Club has come a long way in 95 years. Imagine what being a club member was like 95 years ago. Just as today, members enjoyed casting, fishing trips and club meetings plus the friendship and knowledge of the many seasoned club members. Throughout the club's history, its mission has not changed. The mission of the club establishes the basis of reasons for joining the club. Thus, the reasons for joining the club haven't changed in 95 years.

As club president, I am honored to serve in a role that helps to fulfill the club's chartered mission. Credit and thanks need to be given for the amazing efforts of volunteers, which make wonderful activities and events to transform everyone into competent casters and fly fishers.

The Long Beach Casting Club is well known for holding quality events, clinics and classes where volunteer members showcase leadership and knowledge in fly casting and fishing. So, during the next event, please be sure to thank the streamkeeper, class instructor or event organizer for their efforts.

**Thank you to everyone** who answered the call for help.

My term as Club President is ending and a new Board of Directors will continue to carry on the Club's mission as before. Please accept my warmest thanks to all who have helped me in my two years of memories as Club President. Going forward, please continue to support the new Board of Directors and the Club by volunteering at events, classes, meetings and clinics.

Wishing everyone continued success in casting and learning the science of fly fishing. See you at the Pond!

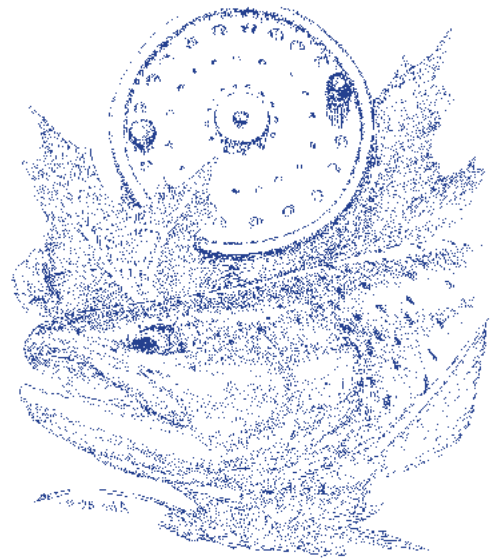

## New Club Members

WAYNE SAKAGUCHI,  
MEMBERSHIP SECRETARY

**T**he Board of Directors approved these new members at the last Board Meeting:

- ❖ Michael & Shirleen Sanborn
- ❖ Whitney Gould
- ❖ Henry Mittel
- ❖ Richard Sullivan

Please greet and welcome our new members at the next monthly meeting. Here's wishing them a lifetime of healthy hatches and tight lines. **Members: if you see visitors at our club meetings, let's make them feel welcome and inform them of the activities we have to offer!**



Joan K. Green, CPA  
joan@GreenZahn.com

1700 East Pacific Coast Highway • Seal Beach, CA 90740  
p 562.799.4440 877.838.3299 f 562.799.4441 www.GreenZahn.com

Member American Institute of Certified Public Accountants • California Society of Certified Public Accountants

## LBCC Awards & Installation Dinner, Date TBD

**Date:** TBD

**Time:** Start at 5:00 pm, Dinner at 6:00 pm

**Place:** Long Beach Casting Club

**Menu (also see potluck portion below):**

**Lasagna  
Garlic Bread  
Salad**

Come and celebrate with us the accomplishments from this past year, thank those who have made the club enjoyable and a success and help us welcome the new board of directors that will be giving so much of their time during the next 12 months to keep our club energized.

-----  
Please mail the following information to our club address below:

Awards and Installation Dinner

**Date:** TBD

**Time:** Start at 5:00 PM, Dinner at 6:00 pm

**Place:** Long Beach Casting Club

**Dinner:** Lasagna, Garlic Bread, Salad

**Pot Luck Assignments:**

Last name begins with: A-M – Hors d'oeuvres; N-Z – Dessert;

**Name:**-----

**Number of people including myself:**-----

**I will be bringing:**-----

**I am willing to help out with preparation, serving, or cleanup:**-----

Send this form on or before Wednesday, April 15, 2020 to:

LBCC c/o A&I Dinner

P.O. Box 90035

Long Beach, CA 90808-0035

Also, in order to help with the headcount, please contact Colin Kumabe: Colin Kumabe (ctkumabe@gmail.com)

Reservations must be received by: Wednesday, April 15, 2020



# Nominating Committee Aims High and Hits the Marks!

**MICK WOODBURY, PAST PRESIDENT**

**T**his year's Nominating Committee has nominated the following members to the 2020–2021 Long Beach Casting Club's Board of Directors.

PRESIDENT:	Steve Jones
1 <sup>ST</sup> VICE PRESIDENT:	TBD
2 <sup>ND</sup> VICE PRESIDENT:	Marc Bonvouloir
CORRESPONDING SECRETARY:	Brad Landon
MEMBERSHIP SECRETARY:	Mark Angelo
TREASURER:	Tom McGivern
CAPTAIN:	Mark Flo/Mike Ivy
FACILITIES & POND:	Steve Higashi
JUNIOR DIRECTOR:	Colin Kumabe
SENIOR DIRECTOR:	Yash Iseda

The proposed slate of officers for the coming year is a good mix of proven experience and new enthusiasm. With three Mark(C)s, the Board of Directors' roll call should start meetings with a bit of humor. The new officers will be voted on **(DATE TBD)** at the Annual General Meeting and installed on **(DATE TBD)** at the Awards and Installation Dinner. The Annual General Meeting is a brief meeting with no guest speaker, and all members are encouraged to attend.

The Annual General Meeting is in lieu of the regular monthly meeting. Any ten members in good standing may nominate other candidates for the same office or offices from the floor at the Annual Meeting. Refer to the Long Beach Casting Club Constitution & Bylaws, Article VIII, Section 5, for the procedure to nominate candidates from the floor at the Annual General Meeting. The Constitution & Bylaws are located in the back of your copy of the LBCC Roster.

**WANTED:** Vice President for highly-visible board position. Candidate must be energetic, dependable and articulate.

Will conduct monthly meetings, arrange for speakers

and host the Venison Stag. Position comes with lots of appreciative support. The pay ain't great, but the satisfaction and sense of accomplishment—humongous. You will meet many interesting and knowledgeable fly fishers.

If you are this person, or know someone who fits the bill, contact Bill Boehlert, John Van Derhoof or Mick Woodbury.

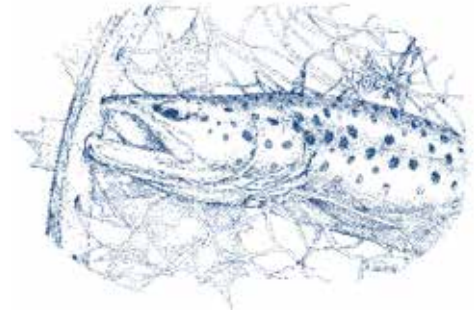

## *In appreciation for the many years of support,*

**B**ob Marriott's is pleased to give 2% of all Long Beach Casting Club member purchases back to the club. This store credit can be used by the club for raffle prizes or toward other product purchases that will help enhance and benefit club activities. When purchasing from Bob Marriott's, please be sure to mention that you are a LBCC member to help ensure a percentage of your sale will go back to the club.



# Southwestern Casting Tournament

## MARK FLO, CO-CAPTAIN

The annual Southwestern Casting Tournament was a great success. There were 27 casters from the San Francisco, Oakland, Pasadena and Long Beach clubs. Our great volunteers made the whole thing possible: scorekeepers, judges, setup crew, takedown crew, kitchen crew and clubhouse crew. Without them there would no tournament. Several people, who weren't officially signed up, jumped in where needed. A very big thank-you to all our volunteers. You are the best!

A very special thanks to John and Thea Lincoln for making and serving our Saturday night Chicken Marsala dinner, and to Mark Lipe for preparing the award medals for the competition. Scores of note for Casting Club members: Nicholas Galvan 99 in Trout Fly, and Craig Kojima 90 and Conley Dees 91 for Trout Fly in their first tournament. Well done!

The all-around winners were: Steve Rajeff (1<sup>st</sup>), Henry Mittel (2<sup>nd</sup>) and Larry Allen (3<sup>rd</sup>).

Congratulations!

### TROUT FLY

A CASTERS		
1	Maxine McCormick	100
2	Steve Rajeff	98 (99)(99)
3	Chris Korich	98 (99)(98)
4	Glen Ozawa	98 (99)(96)
5	Henry Mittel	97
6	John Thiele	95
6	Ralph Hardin	95
8	Mark Flo	94
9	Larry Allen	93
9	Mark Lipe	93
9	Matt Donaldson	93
12	Keith Pryor	91
13	Mark Tsunawaki	86

B CASTERS		
1	Nicholas Galvan	99
2	Chris Walker	92
3	Mariano Domingo	90
4	Whitney Gould	88
5	Mario Rodriguez	86
5	Audrey Wilson	86
7	Elaine Gong	84
8	Rick Hilles	81
9	Alice Gillibert	80

C CASTERS		
1	Conley Dees	91
2	Craig Kojima	90

### BASS BUG

A CASTERS		
1	Glen Ozawa	97 (95)
2	Larry Allen	97 (93)
3	Chris Korich	96
4	Steve Rajeff	95
5	John Thiele	93
5	Ralph Hardin	93
7	Keith Pryor	92
7	Henry Mittel	92
7	Mark Tsunawaki	92
10	Matt Donaldson	91
10	Maxine McCormick	91

B CASTERS		
1	Chris Walker	91 (90)
2	Nicholas Galvan	91 (88)
3	Rick Hilles	89
4	Mark Lipe	88
5	Mark Flo	86
5	Mariano Domingo	86
7	Alice Gillibert	84
7	Whitney Gould	84
7	Audrey Wilson	84
7	Elaine Gong	84
7	Mario Rodriguez	84

C CASTERS		
1	Craig Kojima	81

### 1/4 OZ. ACCURACY

A CASTERS		
1	Steve Rajeff	98 (99)
2	Henry Mittel	98 (96)
3	Chris Korich	97
4	Mark Tsunawaki	94
5	Larry Allen	91
6	Keith Pryor	90

7	Ralph Hardin	86
8	Matt Donaldson	84
B CASTERS		
1	Mark Lipe	88 (86)
2	Nicholas Galvan	88 (85)
3	Alice Gillibert	86 (1)
4	Mariano Domingo	86 (0)
5	Elaine Gong	83
6	Mark Flo	82

C CASTERS		
1	Craig Kojima	86

### OPEN PLUG

A CASTERS		
1	Henry Mittel	97 (98)
2	Steve Rajeff	97 (96)
3	Larry Allen	95
4	Chris Korich	94
5	Ralph Hardin	92
6	Matt Donaldson	91
7	Mark Lipe	90
8	Mark Tsunawaki	88
9	Keith Pryor	85

B CASTERS		
1	Mark Flo	93
2	Chris Walker	88
3	Nicholas Galvan	87
4	Alice Gillibert	86
5	Mariano Domingo	82
6	Elaine Gong	81

C CASTERS		
1	Craig Kojima	85

### 1/4 OZ. DISTANCE

A CASTERS		
1	Henry Mittel	221
2	Steve Rajeff	210
3	Larry Allen	192
4	Mark Tsunawaki	164
5	Matt Donaldson	153
6	Mark Flo	146
7	Ralph Hardin	136

B CASTERS		
1	Nicholas Galvan	141
2	Elaine Gong	112

C CASTERS		
1	Craig Kojima	127

### ANGLER'S FLY

A CASTERS		
1	Steve Rajeff	146 (134)
2	Henry Mittel	144 (143)
3	Larry Allen	136 (134)
4	Matt Donaldson	128 (116)
5	Keith Pryor	121 (112)
6	Mark Tsunawaki	118 (115)
7	Ralph Hardin	118 (107)
8	Mark Flo	116 (113)
9	Chris Korich	108 (108)

B CASTERS		
1	Maxine McCormick	110 (108)
2	Rick Hilles	108 (105)
3	Nicholas Galvan	102 (101)
4	Audrey Wilson	95 (93)
5	Whitney Gould	93 (90)
6	Elaine Gong	89 (85)

C CASTERS		
1	Don Huseman	87 (82)

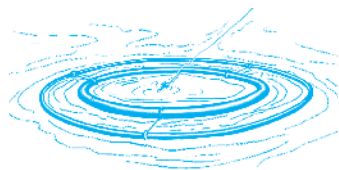

## DRY FLY

### A CASTERS

1	Chris Korich	99 (100x3)	3	Larry Allen	92
2	Steve Rajeff	99 (100x2,99)	4	Keith Pryor	91
3	Henry Mittel	99 (99)	4	Mark Tsunawaki	91
4	Matt Donaldson	99 (98)	6	Chris Korich	90
5	Glen Ozawa	98	7	Matt Donaldson	89
5	Maxine McCormick	98	8	Ralph Hardin	88
7	Ralph Hardin	97			
8	John Thiele	96			
8	Larry Allen	96			
8	Mark Tsunawaki	96			
11	Keith Pryor	91			
11	Mark Lipe	91			
13	Mark Flo	90			

### B CASTERS

1	Chris Walker	95
2	Mario Rodriguez	94 (92)
3	Nicholas Galvan	94 (90)
4	Audrey Wilson	93
5	Whitney Gould	91
6	Mariano Domingo	88
7	Rick Hilles	87
7	Alice Gillibert	87
9	Elaine Gong	85

### C CASTERS

1	Craig Kojima	88
---	--------------	----

## WET FLY

### A CASTERS

1	Steve Rajeff	99 (100)
2	Chris Korich	99 (99)(97)
3	Henry Mittel	99 (99)(95)
4	Keith Pryor	97
4	Maxine McCormick	97
4	Glen Ozawa	97
4	Larry Allen	97
8	Mark Flo	95
8	Ralph Hardin	95
10	Matt Donaldson	92
10	Mark Tsunawaki	92
10	Mark Lipe	92
13	John Thiele	91

### B CASTERS

1	Mariano Domingo	97
2	Alice Gillibert	93 (96)
3	Nicholas Galvan	93 (95)
4	Rick Hilles	90 (88)(89)
5	Elaine Gong	90 (88)(88)
5	Audrey Wilson	90
7	Mario Rodriguez	88
8	Chris Walker	87
9	Whitney Gould	86

### C CASTERS

1	Craig Kojima	89
---	--------------	----

## 3/8 OZ ACCURACY

### A CASTERS

1	Steve Rajeff	99
2	Henry Mittel	96

### B CASTERS

1	Mark Lipe	92
2	Nicholas Galvan	89
3	Mariano Domingo	84 (86)
4	Mark Flo	84 (84)
5	Alice Gillibert	82
6	Elaine Gong	80

### C CASTERS

1	Craig Kojima	87
---	--------------	----

## 5/8 OZ ACCURACY

### A CASTERS

1	Steve Rajeff	97
2	Chris Korich	95
3	Mark Lipe	94 (1)
4	Larry Allen	94 (0)
5	Henry Mittel	93
6	Ralph Hardin	92
7	Mark Tsunawaki	90
7	Matt Donaldson	90

### B CASTERS

1	Mark Flo	89
2	Elaine Gong	84
3	Alice Gillibert	83 (1)
4	Nicholas Galvan	83 (0)

### C CASTERS

1	Craig Kojima	87
---	--------------	----



## ALL DISTANCE COMBINED

CASTER	COMB	AF D	1/4 D
Henry Mittel	365	144	221
Steve Rajeff	356	146	210
Larry Allen	328	136	192
Mark Tsunawaki	282	118	164
Matt Donaldson	281	128	153
Mark Flo	262	116	146
Ralph Hardin	254	118	136
Nicholas Galvan	243	102	141
Elaine Gong	201	89	112
Craig Kojima	127	-	127
Keith Pryor	121	121	-
Maxine McCormick	110	110	-
Chris Korich	108	108	-
Rick Hilles	108	108	-
Audrey Wilson	95	95	-
Whitney Gould	93	93	-
Don Huseman	87	87	-



## ALL ACCURACY

CASTER	COMB	TF	BB	1/4 A	OP A	DF	WF	3/4 A	5/8 A
1	Steve Rajeff	782	98	95	98	97	99	99	97
2	Henry Mittel	771	97	92	98	97	99	99	96
3	Chris Korich	768	98	96	97	94	99	99	90
4	Larry Allen	755	93	97	91	95	96	97	92
5	Ralph Hardin	738	95	93	86	92	97	95	88
6	Mark Tsunawaki	729	86	92	94	88	96	92	91
7	Matt Donaldson	729	93	91	84	91	99	92	89
8	Mark Lipe	728	93	88	88	90	91	92	92
9	Nicholas Galvan	724	99	91	88	87	94	93	89
10	Mark Flo	713	94	86	82	93	90	95	84
11	Craig Kojima	693	90	81	86	85	88	89	87
12	Alice Gillibert	681	80	84	86	86	87	93	82
13	Elaine Gong	671	84	84	83	81	85	90	80
14	Keith Pryor	637	91	92	90	85	91	97	91
15	Mariano Domingo	613	90	86	86	82	88	97	84
16	Chris Walker	453	92	91	-	88	95	87	-
17	Glen Ozawa	390	98	97	-	-	98	97	-
18	Maxine McCormick	386	100	91	-	-	98	97	-
19	John Thiele	375	95	93	-	-	96	91	-
20	Audrey Wilson	353	86	84	-	-	93	90	-
21	Mario Rodriguez	352	86	84	-	-	94	88	-
22	Whitney Gould	349	88	84	-	-	91	86	-
23	Rick Hilles	347	81	89	-	-	87	90	-
24	Conley Dees	91	91	-	-	-	-	-	-

## ALL AROUND

CASTER	ALL A	TF	BB	1/4 A	OP A	AF D	1/4 D	DF	WF	3/4 A	5/8 A
1	Steve Rajeff	13	2	2	1	1	1	2	1	1	1
2	Henry Mittel	19	3	4	1	1	2	1	1	1	2
3	Larry Allen	33	6	1	4	3	3	3	5	3	2
4	Ralph Hardin	50	4	3	6	5	5	8	4	4	7
5	Mark Tsunawaki	52	8	4	3	7	5	4	5	7	4
5	Matt Donaldson	52	6	6	7	6	4	5	1	7	5
7	Nicholas Galvan	62	1	6	5	8	8	7	7	6	5
8	Mark Flo	66	5	8	9	4	7	6	8	4	8
9	Elaine Gong	88	9	9	8	9	9	9	9	9	8



**Best Western.**

**Vicki Arreguin**  
Director of Sales  
dos@goldensailshotel.com

**Golden Sails Hotel**  
6285 East Pacific Coast Highway  
Long Beach, CA 90803  
P: (562) 596-1631  
D: (562) 594-0210  
Reservations: (800) 762-5333  
goldensailshotel.com

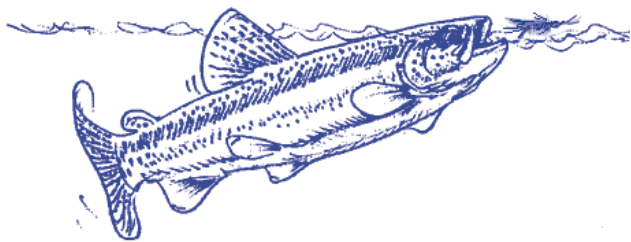

## Membership Renewal!

WAYNE SAKAGUCHI,  
MEMBERSHIP SECRETARY

**T**ime is fast approaching to renew your membership. Membership will be expiring on March 31st/April 1st, you must be an active member to vote during the Annual General Meeting on April 2nd. Also we would like to include you in our 2020-2021 Roster. If you no longer wish to be a member, please let me know. Those of you who have already renewed, thank you. If you aren't sure of your status please email me.

Please mail your renewal form:

(<https://longbeachcastingclub.org/wp-content/uploads/2020/02/LBCC-Membership-Application-Rev-Nov-2016-Fillable.pdf>)

and check to the club address:

Long Beach Casting Club  
PO Box 90035  
Long Beach, CA 90809-0035

or drop it off in the club house office lock box at:

Recreation Park  
7<sup>th</sup> Street and Federation Drive

or pay by paypal/credit card at:

<https://longbeachcastingclub.org/membership/>

Please take action by March 31, 2020 or we will have to remove you and your email address from our roster. Again, thank you for your support.

## Captain's Corner

MARK FLO, CO-CAPTAIN

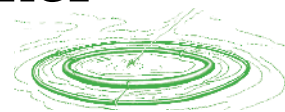

**CASTING:** the Beginning Fly Casting class will be on the pond Tuesday nights beginning March 17 and concluding April 7. We have no official casting in April, but we are at the pond practicing most Tuesday nights and Sunday mornings. **NOTE: THESE EVENTS ARE CANCELLED UNTIL FURTHER NOTICE.**

**TOURNAMENTS:** see this issue of Target Talk, Pages 8-9, for results of the Southwestern Tournament.



## Rod Building Class Starts May 12

EDDIE MADRID, ROD BUILDING CHAIR

**L**earn the steps needed to build your own fly rod. This class covers the basics of component selection and techniques needed to make your own rod. While instruction focuses on fly rods, the techniques covered are applicable to regular fresh and saltwater rods too.

In addition to instruction, class participants have access to specialized building tools to help build that special heirloom rod. No tools are needed for the Orientation Class. Small fee for the Rod Building Manual. Class is free and open to all.

The Orientation Class is Tuesday, May 12, 2020 at 7:00 PM. There is no class May 19. Rod-building begins on Tuesday, May 26 and runs for a total of five weeks of instruction (class meets each Tuesday at 7:00 PM, ends on June 23, 2020).



# Brookie Bash: 22<sup>nd</sup> Year!

MARK FLO, CO-CAPTAIN

The 22<sup>nd</sup> (as far as I can figure out) Annual Brookie Bash will be held Saturday, July 25 in Little Lakes Valley (Sierra Tenkara Event is Friday, July 24). The Pre-Trip meeting is still TBD.

If we have enough people, we will be renting one or two condos for Thursday, Friday and Saturday nights. We need a headcount to determine how many people need to be accommodated. Please contact Mark Flo at [markcflo@yahoo.com](mailto:markcflo@yahoo.com) by Tuesday, March 31 to reserve your spot. You must have your non-refundable \$125 per person deposit to Mark by Sunday, May 31.

Earn the LBCC special pin "The Sadler Slam" by catching all five species of trout that weekend: Brookie, Brown, Rainbow, Cutthroat and Golden.

Remember the immortal words of Jeffrey Sadler:

*"Rookies and Brookies are made for each other!"*

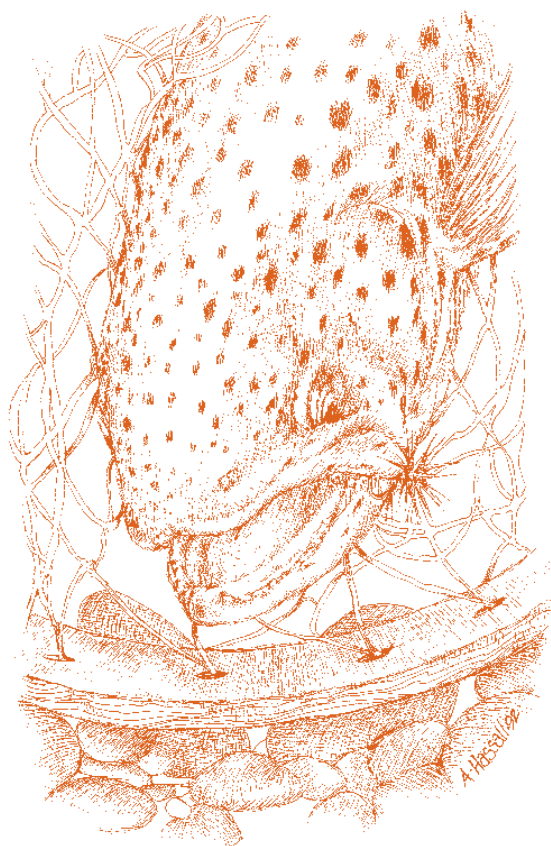

## A Little Note from Your Editor

ROB PETERSON, TARGET TALK EDITOR

Hello, I hope the April Target Talk finds you safe, happy and healthy. These are strange times, and if you search this issue for the word "cancelled", you'll get plenty of hits. Please note (said Captain Obvious) that any remaining event dates you see are subject to change.

It's a good time to tie flies, organize your fly box, even remember how to read a book. Personally, I might practice my "social distancing" tomorrow on an unoccupied stretch of the Sandy River.

Be safe! And best wishes during these very unsettling times.

# Welcome Back, Sockeye Salmon! 100 Years is Far Too Long

ROB PETERSON, TARGET TALK EDITOR

**I**'m involved with a couple of non-profits in Oregon. One is called "Eastern Oregon Legacy Lands". This organization is working with the Nez Perce Tribe to bring sockeye salmon back to Wallowa Lake in northeastern Oregon, after an absence of 100 years. I cannot think of a more worthwhile conservation project.

At the time of Lewis and Clark, there were two major runs of sockeye salmon in Oregon: one on the Deschutes River in the central part of the state, and one on the Wallowa River in the northeast corner. Sockeye salmon normally spend their formative years in a "nursery lake". On the Deschutes River, the nursery lake was Suttle Lake; on the Wallowa River, it was Wallowa Lake.

These runs formed the southern border of the sockeye's range. The Wallowa River run was also the main source of food for the legendary Chief Joseph and the Nez Perce tribe.

Before Joseph and the Tribe were unjustly forced from their home in the Wallowa "Valley of the Winding Waters", the Tribe had lived there for hundreds, maybe thousands, of years. Each spring, they would move from their winter camps in the sheltered river mouths to the southern slopes of the hills. There they collected

kouse roots for the "Time of First Eating". In August and September, they would camp at the south end of Wallowa Lake and wait for the sockeye salmon run.

The run was magnificent, awe-inspiring. Thousands of brilliant red sockeyes jostled and pushed each other on their way up the Wallowa River. According to one source: "These fish were so numerous that the various channels [of the river] appeared as a solid red band. In fact, as the Nez Perce crossed these streams, their horses were sometimes seen to actually kick these fish out on the bank."

The Nez Perce say that families often caught a year's supply of salmon in one net. The sockeye run was the Tribe's main food source and a keystone of its culture. Of every ten meals for a Nez Perce family, nine were salmon.

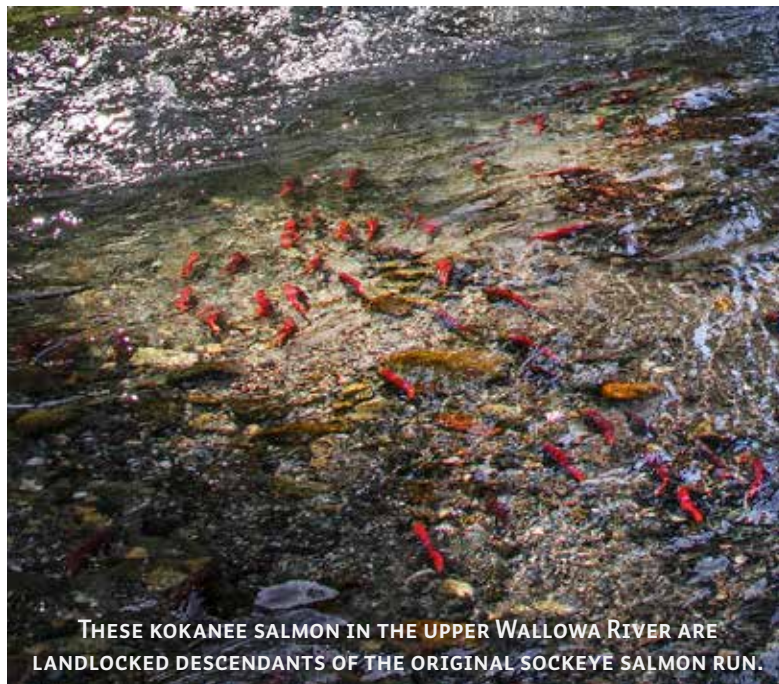

THESE KOKANEE SALMON IN THE UPPER WALLOWA RIVER ARE LANDLOCKED DESCENDANTS OF THE ORIGINAL SOCKEYE SALMON RUN.

After refusing to sign the "Thief Treaty" of 1863, the Tribe's relations with its white neighbors worsened. In 1877, Joseph and the Nez Perce began their famous 1,170-mile flight, pursued by the U.S. Army. They were captured

40 miles from the Canadian border, and were never allowed to return to their beloved Valley of the Winding Waters. A dam was built on Wallowa Lake in 1919; soon afterward the sockeye salmon disappeared.

But in 1996, the Wallowa Lake Dam was listed as a "High Hazard Structure". Since then, the Nez Perce Tribe has worked with local conservation groups and irrigators to get it refurbished. And now, a hundred years after the dam was completed, the State of Oregon has funded the "reconstruction" of the Wallowa Lake Dam.

This reconstruction effort includes fish passage, which is needed to make sockeye salmon reintroduction feasible. The appropriation is \$14 million, to be supplemented by grants which will raise the total budget to \$16 million. The reconstruction is currently scheduled to be completed “sometime in 2022”. The Tribe is working to realize a 100-year old dream: to re-introduce sockeyes to the Wallowa River.

Reintroduction of sockeye salmon has always been a major goal of the Nez Perce Tribe; they’ve been planning for it for many years. The Nez Perce Tribal Fisheries Department is currently doing limnological and prey base studies in Wallowa Lake. The department is well respected and has done some very good work re-establishing Coho salmon in the Wallowa and Clearwater River systems.

The historic prime spawning area for sockeye is the inlet of the Wallowa River at the south (upper) end of the lake. This area is in a nearly pristine state now. It is adjacent to the Wallowa Lake Lodge, a beautiful old resort hotel with a long history (I’ve stayed there). The owners had planned to put it up for auction, but a group of investors led by Eastern Oregon Legacy Lands, with help from the Nez Perce Tribe, purchased it instead.

This quote from the previous owner should shed some light on the reasons for the purchase: “For many years we have striven to assure the lodge property and the whole south end of the lake would be preserved in its natural state for the use and enjoyment of future generations. The new community-based ownership shares our hopes and dreams, and is uniquely positioned to achieve that goal. Their efforts have earned our strong support.”

The adjacent spawning area would be covered by a permanent conservation easement. The agreement between the lodge owners and the Tribe calls “for the Nez Perce Tribe to hold a conservation easement, which the tribe will purchase. The easement will prohibit development on most of the open ground of the lodge area, including the Wallowa River wetlands and adjacent uplands.”

This easement would be in place, in perpetuity, to protect spawning habitat for the anticipated sockeye salmon run, which is central to the cultural values of the Tribe. It would also protect habitat for kokanee salmon and bull trout, as well as nesting bald and golden eagles.

The map on the following page (pg. 12), "Wallowa Lake Basin Land Conservation Projects", shows Wallowa Lake. At the very southern (bottom) tip of the lake, "Wallowa Lake Lodge" is shown in black lettering. The area in yellow around the lodge is the conservation easement.

The map on the next page (pg. 13), "Wallowa Lake Lodge", shows the area of the conservation easement in detail. Zone A, which includes the upper Wallowa River, is the protected area where the salmon will come to spawn. Zone B will provide wildlife habitat, especially for nesting bald and golden eagles.

The Tribe is raising the money for the conservation easement. It has so far raised \$700,000, but still needs an additional \$325,000.

Anyone who has seen the inspiring beauty of a sockeye salmon run knows that it is a miracle of nature. Please consider making a contribution, and helping the Nez Perce Tribe to bring this miracle back to the “Valley of the Winding Waters”.

Just send a check to the following address, with a cover note specifying that it's earmarked for the Wallowa Lake Conservation Easement (you can also note that on the check byline).

### **Send to:**

Ann McCormack, Economic Development Planner  
Economic & Community Transportation Planning  
Nez Perce Tribe  
P.O. Box 365  
Lapwai, Idaho 83540

**Thank you from the bottom of our hearts!**



## Wallowa Lake Basin Land Conservation Projects

Summer 2019

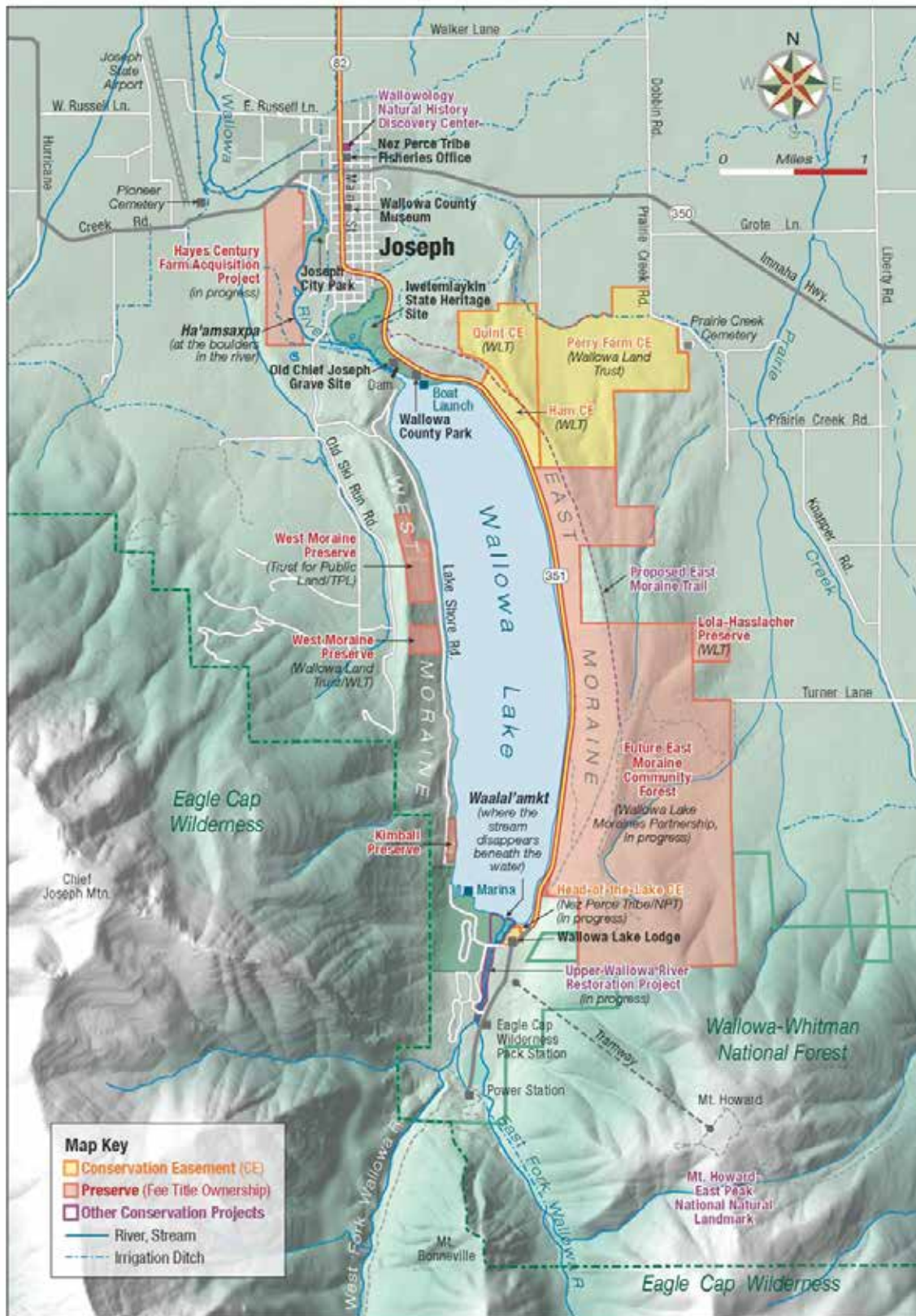

Status: Conservation easements and land acquisitions across Wallowa Lake Basin, led by Wallowa Land Trust, with Wallowa Resources, Oregon State Parks, Wallowa County, Nez Perce Tribe, Trust for Public Land, and Eastern Oregon Legacy Lands. Map by Wallowology/EOLL • August 2019



# Wallowa Lake Lodge

60060 Wallowa Highway  
Joseph, Oregon 97846  
[www.wallowalake.com](http://www.wallowalake.com)

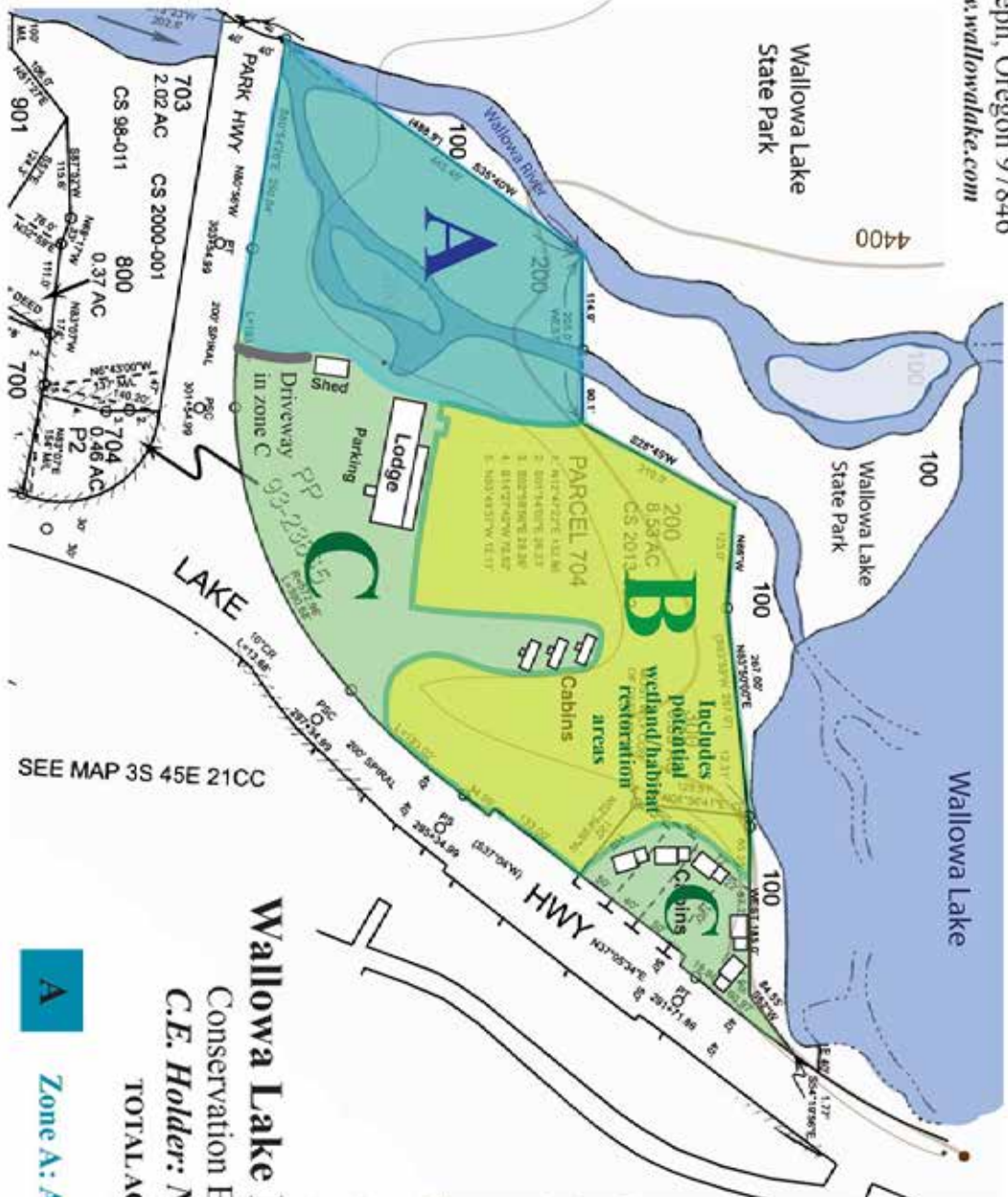

Contour lines from  
USGS 7.5' quadrangle,  
Joseph, Oregon

## Wallowa Lake Lodge Property

Conservation Easement Zones  
*C.E. Holder: Nez Perce Tribe*

TOTAL ACRES: 9.22

- A** Zone A: AQUATIC HABITAT
- B** Zone B: OPEN SPACE/HABITAT
- C** Zone C: BUILDING ENVELOPES



## Spring is Upon us Here in the Eastern Sierra!!!

It's an early spring, and the creeks and rivers are all fishing very well right now. Call me if you'd like to get into some early season action! Give me a call if you'd like to book a trip for this fishing season.

**CHRIS LEONARD - 818.288.3271**

I offer half-day and full-day trips. Moving waters and Crowley Lake.



## LBCC Pyramid Lake Float Tube Outing W/Rob Anderson & Pyramid Lake Fly Fishing ❖ May 31–June 2, 2020



CHANCE TO CATCH  
THE TROUT OF A LIFE TIME!



- WHEN:** Fishing May 31–June 2; Sunday through Tuesday. Arrive Saturday May 30, depart Wednesday June 3.
- GUIDES:** Provided by Rob Anderson and guides from Pyramid Lake Fly Fishing Guide Service (PLFFGS). Website: [www.pyramidlakeflyfishing.com](http://www.pyramidlakeflyfishing.com). Phone: 775-742-1754.
- COST:** **\$335.00**. Includes hot breakfast, lunch & drinks on fishing days and guide assistance.
- LODGING:** Preferred Hotel – Western Village Inn & Casino, Sparks, NV. Block of rooms have been secured and excellent room rates have been negotiated. Anglers call and reserve your room at 800-648-1170.
- WHAT YOU ARE RESPONSIBLE FOR:** Your Transportation, Hotel, Meals (other than breakfast and lunch on fishing days at the lake) Guide tips, Fishing Permit (from Paiute Indian Tribe).
- FISHING GEAR:** Bring your own Float Tubes, Pontoon Boats, Kayaks (PLFFGS has limited crafts for rent), Rods/Reels (7, 8 or 9 wt. with fast sinking shooting head line) & Tackle. We will be fishing in 30' of water. PLFFGS will provide recommendations and you can purchase flies and leader kits from them prior to the trip.
- MORE:** ❖ Trip is limited to 16 anglers. We have 12 signed up and paid. Join us for a great time on a beautiful unique lake with an excellent chance at getting a "double digit" Lahontan Cutthroat.
- ❖ Deposit of **\$170.00** due no later than February 1, 2020.
- ❖ Final deposit of **\$165.00** due no later than April 1, 2020. Make check payable to the 'Long Beach Casting Club', and send to LBCC, PO Box 90035, Long Beach CA. 90809.
- ❖ Contact Paul Nakamura for details and to get on the Outing List. [pnaka1946@gmail.com](mailto:pnaka1946@gmail.com)
- ❖ Pre-Trip Meeting will be scheduled prior to the trip and more details will be sent to members who have signed up for the Outing.
- ❖ PLFFGS will provide Trip Planning and Fishing Details to help you prepare for the Outing.

# Fly Tying Tip: Alternate Tools

DAVE BOYER, MEMBER

**W**hen you create a dubbing loop and use a spinner (PHOTO #1), have you then tried to wrap/palmer the dubbing noodle with the spinner still attached? Awkward!

Instead use an electrical clip (aka electrical lead clip or test clip), wrap the thread a couple of times around the clip, then you can cut the thread and have a less bulky holder to wrap your dubbing in place (PHOTO #2 and PHOTO #3). Just be careful not to release the clip before you palmer and tie off your dubbing, as it will unwind!

They also make a great third hand to hold small materials so you do not lose them on your tying desk. When I have a length of trigger point fibers, a single strand of flash, or a single CDL (Coq de Leon) feather I use for tails, I hold the excess with the

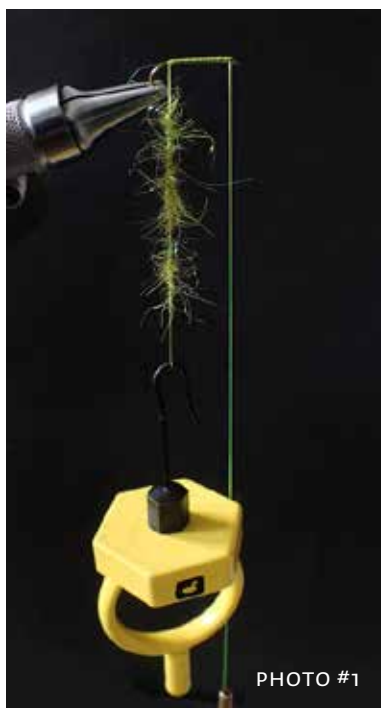

PHOTO #1



PHOTO #2



PHOTO #3

clip. The material is easily held and much easier to find or keep from blowing off your desk as you tie multiple flies (PHOTO #4).

Some tiers will use these clips as hackle pliers but beware: the curved copper hook that holds your material(s) can be sharp and you will end up cutting more hackles than you wind!

Items can be found at electrical supply stores such as Orvac (California) or Altex (Texas) or through the internet. Search for Multimeter Part Colorful Electrical Testing Hook Clip Grabber, or similar.



PHOTO #4



# Fly of the Month: Madison River Improved Zelon Midge

JOHN VAN DERHOOF, EDITOR

**I**n case you haven't figured this out yet (after all these years), I am obsessed with midges. I am also obsessed with fishing midges dry and while, ironically, I am known for tying complex, mind bending Atlantic Salmon Fly patterns (at least back when I was young and had eyes...), my personal choice is an obsession with simplicity—yes, I can be quite lazy given a choice. Well the Madison River Improved Zelon Midge fits perfectly with all three of these foibles of mine, to a tee.

I have been using a similar pattern to this for years and my weekly edition of the Blue Ribbon Flies News showed me a simpler and cleaner way of tying a great fly that is incredibly effective. Now, I offer it to you!

Using dry fly midge imitations to free-rising trout can be a painfully non-productive process. The fly needs to be low in profile but not sink like a rock as soon as it hits a bit of turbulence. The fly also needs to mimic the appearance of the natural in some representative fashion or the trout will reject it outright. The Madison River Improved Zelon Midge seems to be able to manage that all of that with aplomb.

Here is one last reason to give this pattern a try...what is the one mayfly here in California in general and the Sierras specifically that always seems to hatch at about the same time as or in the same water-type that midges do? What mayfly seems to be pervasive in the areas where this club and its members seem to fish the most? If your answer is the Blue-Winged Olive then you are correct and this fly will pretty much match it perfectly.

I tie this in only a couple of sizes: 20, 22 and 24 **AND** I prefer using standard dry fly hooks for this instead of a midge/emergent style hook. Tie this fly in two colors: light dun Zelon shuck and wings with an olive thorax and olive shuck with light dun wings with a very dark olive thorax. The first combo is more indicative of a midge and the second matches Blue-Winged Olives as well. Use olive thread in both cases and, of course, if you find another combination let all of us know about it. One final note to consider: if the guys from Blue Ribbon recommend this fly, it works!

## MATERIALS FOR TYING THE MADISON RIVER IMPROVED ZELON MIDGE:

Hook: Tiemco 101 Ring-eye #20–24 or similar  
 Thread: Size 6/0 or 8/0 Olive (personally, I like using Veevus 12/0)  
 Shuck/Tail: Light dun Zelon  
 Body: Olive Zelon tail/Shuck with wide spaced olive thread over it  
 Wing: Light dun Zelon tied spent wing spinner style  
 Thorax: Olive Ice dubbing  
 Head: Olive thread

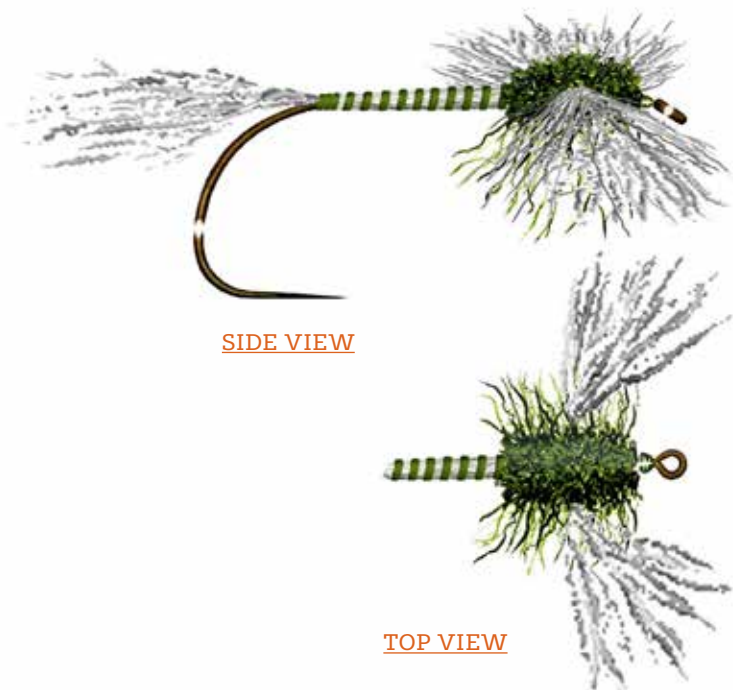



## INSTRUCTIONS ON TYING THE MADISON RIVER IMPROVED ZELON MIDGE:

- 1 Attach your thread to the hook at the headspace. Wind down to the bend of the hook and select about 12 to 24 strands (depending on the hook size) of the Zelon shuck. Tie these strands in so that they are the length of the hook shank or a bit less.
- 2 Advance the thread forward to the thorax using wider than normal spacing, allowing the Zelon shuck to just peek through underneath. If you want to make the fly a bit more durable then, when you are done, put a drop of head cement on the body.
- 3 Again, select another bunch of Zelon for the wing, comprised this time of about 20 to 30 strands depending on the hook size. Attach these strands, laid out flat, on either side of the hook in the same manner as you would tie in a mayfly spinner wing using X-wraps. Once secured, trim the wings so they are about  $\frac{3}{4}$  the length of the shank. I do this by grabbing and pinching both wings together, pulling them back to the tail and then trimming them simultaneously to the desired length.
- 4 Finally, apply dubbing thinly to your tying thread and make one or two complete turns behind the wing, using these turns to slightly push the wing forward as shown in the drawing. Then continue with one complete diagonal (front to back) X-wrap before finishing with another complete wrap or two in front of the wing. If you do not make the complete diagonal X-wrap you will leave a "hole" in the bottom of your thorax exposing the hook and the tie down point of the wing underneath. Also, when you wrap in front of the wing, try not to push the wings back—keep them pointing forward.
- 5 Form a small head, whip finish, apply head cement and you're done. One last thing that helps in finishing off these tiny flies... I like to keep a couple of leftover hackles lying around my tying desk. What I am referring to are the tips of a hackle that are left when you are done wrapping it. Use these

to run through the hook eye of even the tiniest size to clear it of wet head cement. You will thank me the next time you easily slide your fly onto your tippet!



## 15% Discount from Chao Hang & Aventik

PAUL BURGNER, MEMBER

**C**hao Hang of Aventik is offering LBCC members a **15% discount** on the below products. To take advantage of the offer, go to the club page and click on Sponsors. Then click on (Aventik). The Aventik (Amazon) page will come up. Type the ASIN # in the search area (example: ASIN B079NBK9L4). The product will come up.

When checking out use code **XAENV493** for the discount. The list and code will change from time to time, and we'll list it in the current Target Talk.

### Items for this Month:

- ❖ Transparent Plastic Waterproof Fly Box  
Asin: B081CMN832
- ❖ Sinking Tip Fly Line 5f/s  
Asin: B07Y2ZGRFF
- ❖ Trout Net  
Asin: B073LM8K62
- ❖ Aventik 130pc 10mm Fish Eye Beads  
Asin: B0829HDH93
- ❖ 30pc combo Plastic fishing rattle  
Asin: B083Q5PHCT
- ❖ II Generation Rotary Fly Tying Vise  
Asin: B081ZYR36T
- ❖ Fly Fishing Combo  
Asin: B083LPZDTL
- ❖ 2nd Generation High Reel  
Asin: B07JM4KWBR

**FISHING**

**AMMO**



**HUNTING**

**ARCHERY**

963 N. Main Street  
Bishop, CA 93514

**BISHOP, CALIFORNIA**

**PH (760)872-3000**

**FAX (760) 872-8000**



## New Trip Announcement

2020 and Early 2021 Season

**BELIZE ♦ SASKATCHEWAN, CANADA ♦ TIERRA DEL FUEGO & SANTA CRUZ, ARGENTINA**

### New Destinations; New Experiences –

We are excited to announce 3 new destinations being added to 2020 – early 2021 season:

#### **BELIZE RIVER LODGE, BELIZE**

May 21-28, 2020 ♦ **\$4,575-6,325**

TARGET SPECIES: Tarpon, Permit, Bonefish, Snook  
7 nights ♦ 6 days of fishing ♦ including 2 nights in Long Cay Outpost Lodge  
Single Lodging and Single Guide options available  
6 rods available

#### **LAWRENCE BAY LODGE, NORTH SASKATCHEWAN**

July 2-9, 2020 ♦ **\$4,900**

TARGET SPECIES: Northern Pike  
7 nights ♦ 6 days of fishing  
8 rods available

### **TWO PATAGONIA TRIPS IN 2021**

**Estancia Maria Behety, Tierra Del Fuego, Argentina**

January 2-9, 2021 ♦ **\$6,600**

TARGET SPECIES: Sea-Run Browns  
7 nights ♦ 6 days of fishing  
8 rods available

#### **ESTANCIA RIO CAPITAN, ARGENTINA**

January 9-16, 2021 ♦ **\$5,900**

TARGET SPECIES: Rainbows  
7 nights ♦ 6 days of fishing  
6 rods available

As many of you requested, we are letting you know about these trips far in advance. Please let us know if you would like to reserve a spot or would like more information about any of the new trips mentioned here.

# Calendar of Events (April Events at LBCC Cancelled)

## April

1	Wednesday	7:00 PM	Fly Tying Forum — <b>CANCELLED</b>
2	Thursday	7:00 PM	Annual General Meeting — <b>POSTPONED TBD</b>
7	Tuesday	7:00 PM	Beginning Fly Casting — <b>POSTPONED TBD</b>
8	Wednesday	7:00 PM	Fly Tying Forum — <b>CANCELLED</b>
9-10	Week		Kelsey Bass Ranch w/ Mick Woodbury
15	Wednesday	12:00 PM	Nooner Lunch — <b>CANCELLED</b>
		7:00 PM	Fly Tying Forum — <b>CANCELLED</b>
18	Saturday	9:00 AM	Pre-Trip: Green River #1, #2, #3 — <b>CANCELLED</b>
		5:00 PM	Awards & Installation Dinner — <b>POSTPONED TBD</b>
22	Wednesday	12:00 PM	Fly Tying Forum — <b>CANCELLED</b>
26-May 1	Week		Green River #1 w/ Yash Iseda
29	Wednesday	7:00 PM	Fly Tying Forum — <b>CANCELLED</b>

## May

3-8	Week		Green River #2 w/ Colin Kumabe
4	Monday	7:00 PM	Board of Directors Meeting
6	Wednesday	7:00 PM	Fly Tying Forum
9	Saturday	9:00 AM	Beginning Spey Casting
10-15	Week		Green River #3 w/ Paul Burgner
12	Tuesday	7:00 PM	Rod Building
		7:00 PM	Pre-Trip: On the Bay Salt Trip w/ Mark Flo and Kevin Green
13	Wednesday	7:00 PM	Fly Tying Forum
16	Saturday	9:00 AM	Pre-Trip: Pyramid Lake
20	Wednesday	12:00 PM	Nooner Lunch
		7:00 PM	Fly Tying Forum
23	Saturday	9:00 AM	Beginning Spey Casting
24	Sunday	6:00 AM	On the Bay Salt Trip
26	Tuesday	7:00 PM	Rod Building
27	Wednesday	7:00 PM	Fly Tying Forum
28	Thursday	7:00 PM	Monthly Meeting: Corey Shizaki
30-June 3	Week		Pyramid Lake w/ Paul Nakamura

## June

1	Monday	7:00 PM	Board of Directors Meeting
2	Tuesday	7:00 PM	Rod Building
3	Wednesday	7:00 PM	Fly Tying Forum
6	Saturday	9:00 AM	Beginning Spey Casting
9	Tuesday	7:00 PM	Rod Building
10	Wednesday	7:00 PM	Fly Tying Forum
16	Tuesday	7:00 PM	Rod Building
17	Wednesday	7:00 PM	Fly Tying Forum
20	Saturday	9:00 AM	Beginning Spey Casting
23	Tuesday	7:00 PM	Rod Building
24	Wednesday	7:00 PM	Fly Tying Forum
25	Thursday	7:00 PM	Monthly Meeting: Vaughn Podmore



JUNKYARD SPEY



[WWW.OLDMOEGUIDESERVICE.COM](http://WWW.OLDMOEGUIDESERVICE.COM) • 435-885-3342



[www.bobmarriotts.com](http://www.bobmarriotts.com)  
[info@bobmarriotts.com](mailto:info@bobmarriotts.com)  
 2700 W. Orangethorpe Ave.  
 Fullerton, CA 92833

**GOING GREEN...**

We now offer a full service Equipment Recycling Program that saves resources... and puts some "green" on an account for you here at the shop!

[www.bobmarriottsflyfishingstore.com/going-green](http://www.bobmarriottsflyfishingstore.com/going-green)

Store (714) 525-1827 Travel (714) 578-1880



YOUR FLY FISHING DESTINATION  
 & RESORT OUTFITTER

FLY FISHING EXCURSIONS • CLASSES  
 PRIVATE INSTRUCTIONS

**(310) 749-6771**

3901 Brayton Ave., • Long Beach, CA 90807 • [www.spfadventures.com](http://www.spfadventures.com)



**hotel CURRENT**

**NIA ENG**  
 DIRECTOR OF SALES

5325 e. pacific coast highway • long beach, ca 90804  
 direct 562.597.1341 x 117 • facsimile 562.597.8741  
[nia@hotelcurrent.com](mailto:nia@hotelcurrent.com) • [www.hotelcurrent.com](http://www.hotelcurrent.com)